

APPLICATION:

Silos, deposits, multi-cell scales & general machinery

CAPACITY RANGE:

150kg - 300kg - 500kg - 1t - 2t* - 3t*

MATERIAL:

Stainless Steel

ENVIRONMENTAL PROTECTION:

IP68

CHARACTERISTICS

Construction using stainless steel.
The laser soldered closing protects from the typical environment in food and chemical industry.
Mounting compatibility.
Anti-slip shock absorber included.

APPLICATIONS

The CRI FP model is manufactured to maintain its performance capabilities in the environmental conditions existing in industries, where tasks and cleaning demand a good environmental protection.

OPTIONS

Length of the cable is optional.

Hostile environmental cable.

ATEX option

EC-Type examination certificate

CEC 11 ATEX 040 X according directive 94/9/EC

II 1G EEExia IIC T6 (Ta2-0÷+40°C)
TX (Ta-20÷+65°C)

II 1D tD A20 TX°C (Ta-20÷+40°C)
TX°C (Ta-20÷+65°C)

For more information look up the EC-type examination certificate, and documentation.

Consult for special requirements.

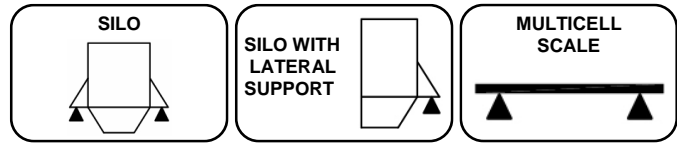

TEFLÓN® protects all the internal cables

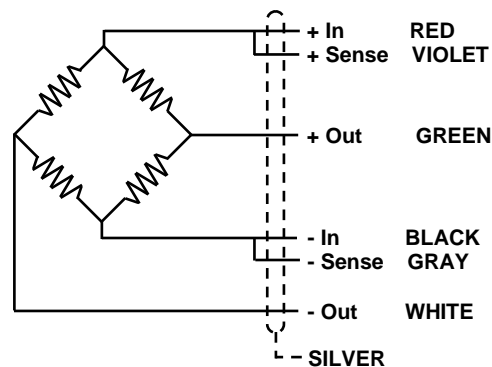
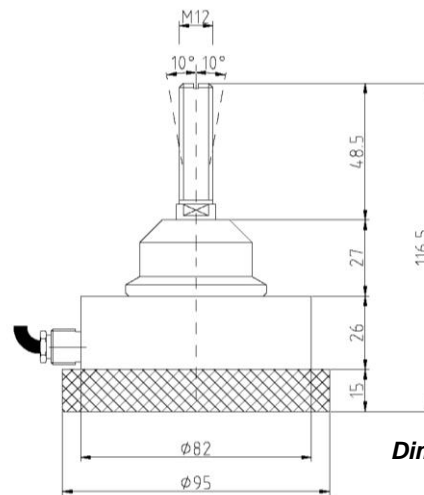

GENERAL TECHNICAL CHARACTERISTICS FOR $g = 9,8031 \text{ m/s}^2$

OIML Class	C2	UNITS
Divisions n_{LC}	2000	
Minimum Dead load E_{min}	0	kg
$Y = E_{max} / V_{min}$	10000	
Rated Capacity E_{max}	150 - 300 - 500 - 1000 2000 - 3000	kg
Rated Sensitivity C	$2 \pm 0,1 \%$	mV/V
Rated Input Voltage	10	V dc
Input Voltage Range	5...15	V ac/dc
Input Resistance R_{LC}	$1100 \pm 10\%$	Ω
Output Resistance	$1000 \pm 10\%$	Ω
Zero Balance	± 2	% E_{max}
Insulation Resistance at 50 V DC	> 5000	M Ω
Service Overload	> 150	% E_{max}
Elim.	> 300	% E_{max}
Temperature Range	- 10 ... 40 : Operating - 30 ... 85 : Storage - 30 ... 90	$^{\circ}\text{C}$ $^{\circ}\text{C}$ $^{\circ}\text{C}$
Max. Non-linearity	0,03	% E_{max}
Max. Hysteresis	0,015	% E_{max}
Max. No repeatability	0,01	% E_{max}
M Max. Creep in 4 hours	0,03	% E_{max}
Max. Zero Recovery Test in 1/2 hour	0,007	% E_{max}
Max Temperature effect	: On Sensitivity : On Zero	% $E_{max} / ^{\circ}\text{C}$ % $E_{max} / ^{\circ}\text{C}$
Cable Length	5	m
Environmental Protection	IP68 - DIN 40050 (100h 1m)	

INSTALLATION SAMPLE



ISO 9001

www.ascellsensor.com
info@ascellsensor.com

 Made in EUROPE

Tel: (+34) 93 776 60 89
Fax: (+34) 93 775 14 72

These specifications are subjected to changes, due to continuous improvement of the design.

ft_en_cripf_101022