

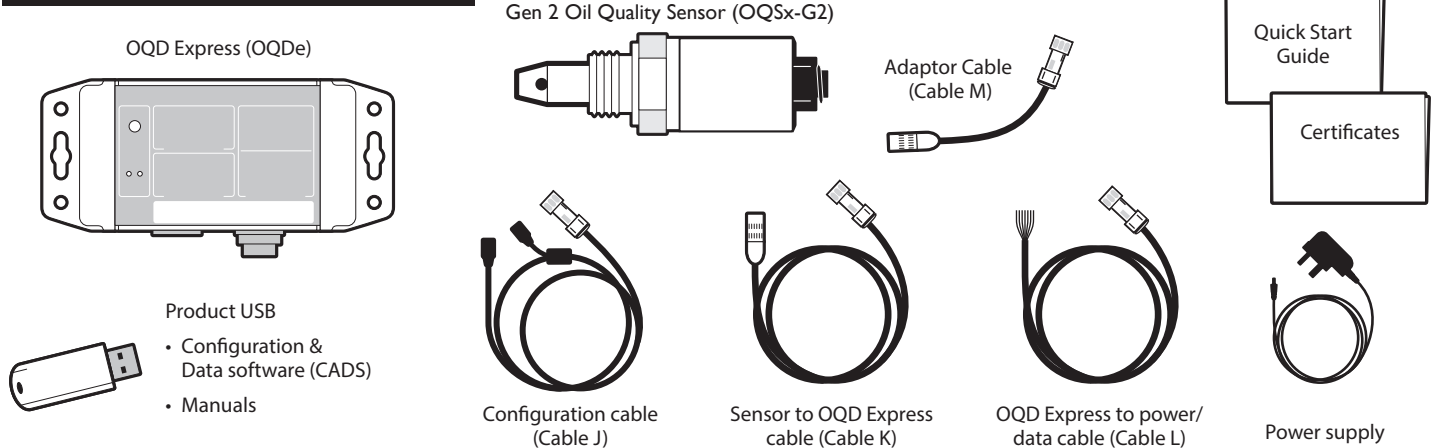



What's in the box?



1. Configure OQSx-G2

-  Allow Configuration cable to update Drivers
-  Install CADS
-  Select correct oil type and communication protocol

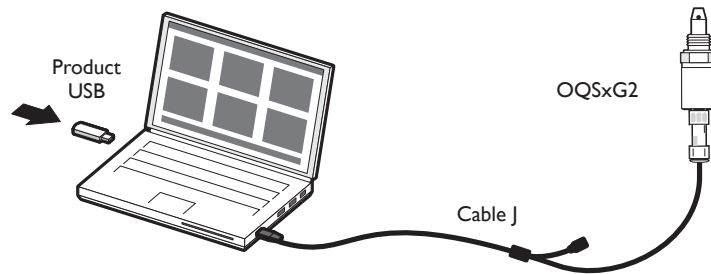

2. Install

ORIENTATION

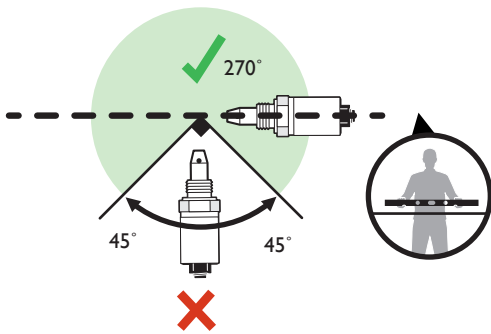

IMMERSION

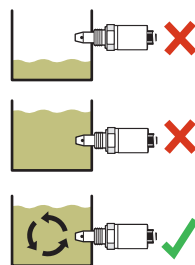

LOCATION OPTIONS

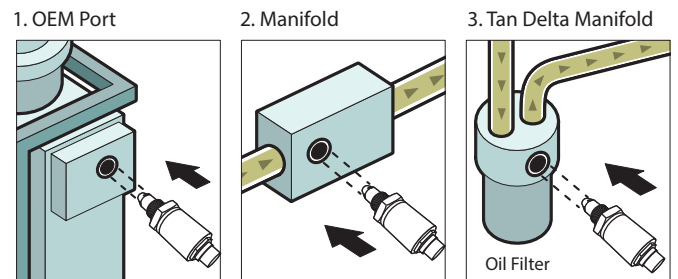



 Sensor may not function if installed incorrectly

I. Configure OQDe

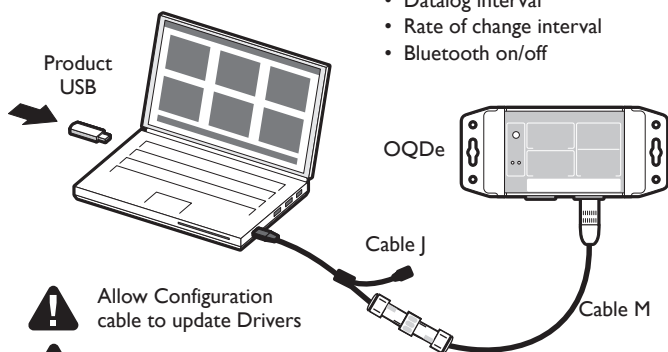
-  Configuration parameters:
 - Warning and alarm levels
 - Temperature units
 - Datalog interval
 - Rate of change interval
 - Bluetooth on/off



-  Allow Configuration cable to update Drivers
-  CADS

NOTE Please complete and return survey

Default configuration

(Quality warning thresholds are configurable)

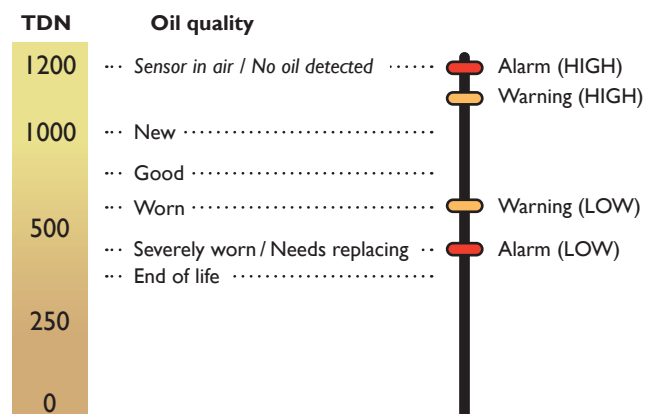

2. Install and connect

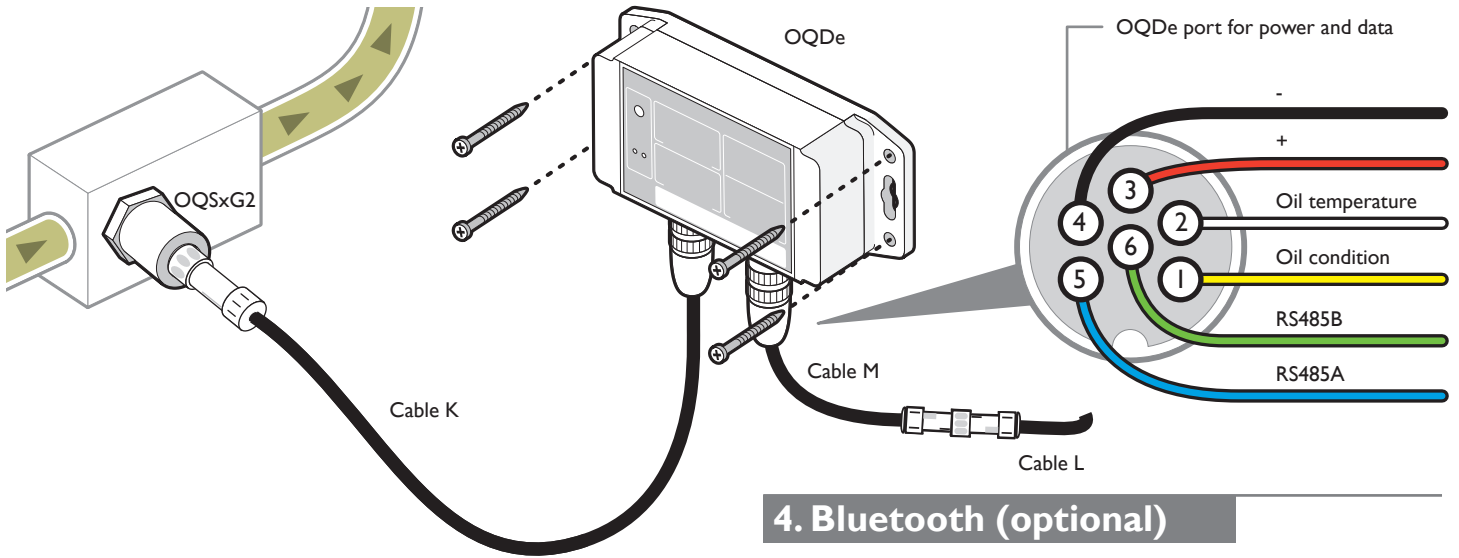

4. Bluetooth (optional)

Download App, connect to OQDe



NOTE: Ensure sensor configured correctly - refer to sensor manual

5. Activation steps

- Check installation
- Power On
- Wait for 1 minute
- Check output

Troubleshooting

1. Check configuration (steps 1+3)
2. Refer to manual
3. www.tandeltasystems.com/install/FAQ
4. support@tandeltasystems.com

Tan Delta System Architecture

